



**22 Burleigh Drive BURNS BEACH WA**

4  2  2 

Open By Appointment Call To View.

On arrival at 22 Burleigh, you immediately feel the calm this quality home and beachside living will bring. Perched perfectly in a friendly street amongst high caliber properties, this is the HOME you have been looking for.

From the moment you enter, the high ceilings and wide entrance envelopes you, welcoming you to this luxurious abode. This home has been configured to transition with your family, ensuring your needs are met through every stage of life.

The intelligent design is realized immediately with a study and the grand master suite located at the front of the home.

[For full version visit the website](https://www.joyofhope.com.au)

**Type** : House  
**Building Size** : 33 sqm  
**Land Size** : 576 sqm  
**View** : <https://www.joyofhope.com.au/sale/wa/northern-suburbs/burns-beach/residential/house/7533720>



**Johann Dique**  
0430041111

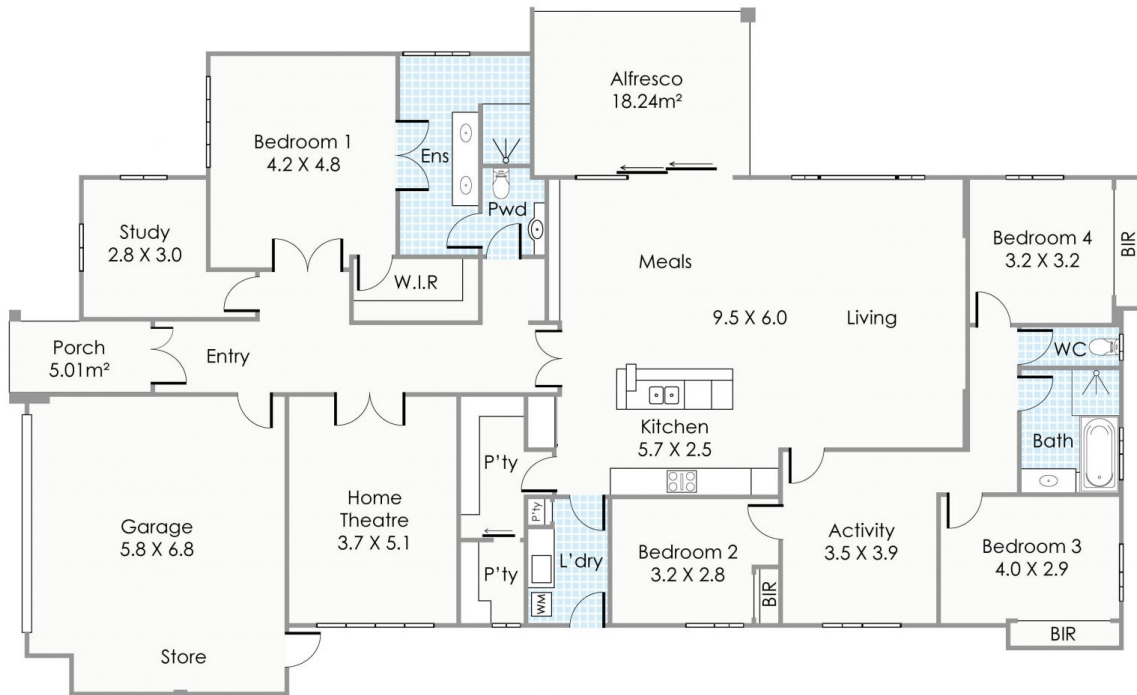

Approximate Areas

Residence:	244m <sup>2</sup>
Garage/	
Store:	42m <sup>2</sup>
Porch:	5m <sup>2</sup>
Alfresco:	18m <sup>2</sup>
Total Area:	309m <sup>2</sup>

This floorplan is for illustration purposes only to show the layout of the property. Not to be used for any other purpose. [www.cribcreative.com.au](http://www.cribcreative.com.au)



**22 Burleigh Drive, Burns Beach**