





11 Syrinx Place MULLALOO WA

7  3  2 

Spanning two storeys and nestled in elevated cul-de-sac tranquillity, this unique 7 bedroom 3 bathroom coastal haven can be whatever you want it to be including an ultra-comfortable home for two separate families, one large extended family or a short-term Airbnb-style accommodation option where valuable extra income is just waiting to be earned.

Should you choose the latter, you can split the property in two with separate entrances complemented by both upstairs and downstairs kitchens and bathrooms. At the rear, a shimmering below-ground swimming pool can be utilised in any way, shape or form, with room to entertain both beside it and underneath the pitched outdoor patio area.

[For full version visit the website](https://www.joyofhope.com.au)

Type : House
Building Size : 28 sqm
Land Size : 769 sqm
View : <https://www.joyofhope.com.au/sale/wa/northern-suburbs/mullaloo/residential/house/7533771>



Johann Dique
0430041111

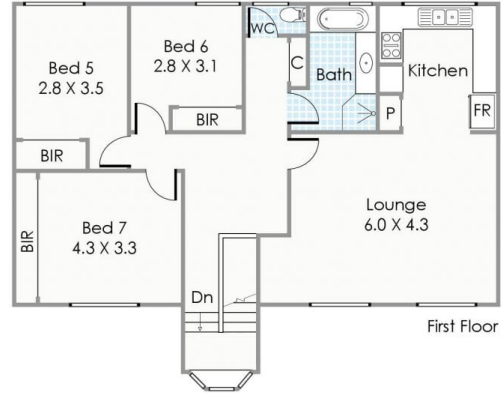
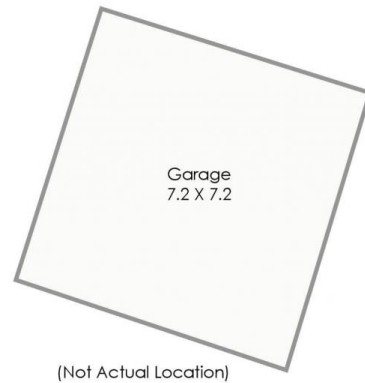
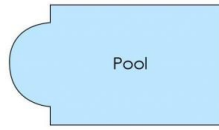
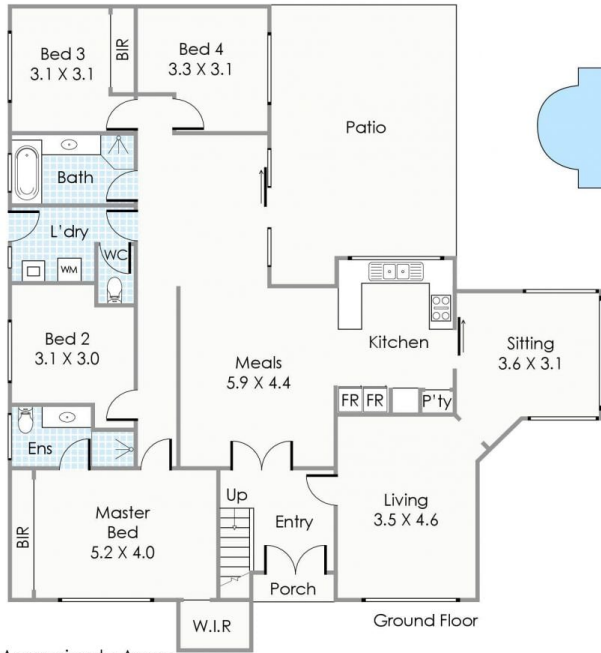

Approximate Areas

- Ground Floor: 157m²
- First Floor: 100m²
- Garage: 52m²
- Patio: 32m²
- Porch: 1m²

Total Area: 342m²

This floorplan is for illustration purposes only to show the layout of the property. Whilst every effort has been made to ensure the accuracy of this floor plan, all measurements, and any other information shown are an approximate interpretation only. Measurements and total areas do not include or account for wall thickness or roof area under eaves. Crib Creative will not be held liable or responsible for any error, omission, misrepresentation or use of any information shown on the final floor plan. Not to be used for any other purpose.
www.cribcreative.com.au



11 Syrinx Place, Mullaloo