



## 2 Sloman Lane CLARKSON WA

3  2  2 

Just lock-up, leave and enjoy the excellent elevated location that this modern 3 bedroom 2 bathroom two-storey home so impressively offers, sharing its commanding corner position with private laneway access from the rear and a gated north-facing street-front main courtyard entrance, sure to please those who love to come and go at their own leisure and without a worry in the world.

Downstairs, the two carpeted front bedrooms both have mirrored built-in wardrobes and are serviced by a sleek main bathroom with a shower, toilet, stone vanity and stylish light fittings. A large front lounge room is also carpeted for comfort and benefits from a pleasant leafy north-facing aspect.

**Type** : House  
**Building Size** : 27 sqm  
**Land Size** : 336 sqm  
**View** : <https://www.joyofhope.com.au/sale/wa/northern-suburbs/clarkson/residential/house/7533785>



**Johann Dique**  
0430041111

[For full version visit the website](https://www.joyofhope.com.au)

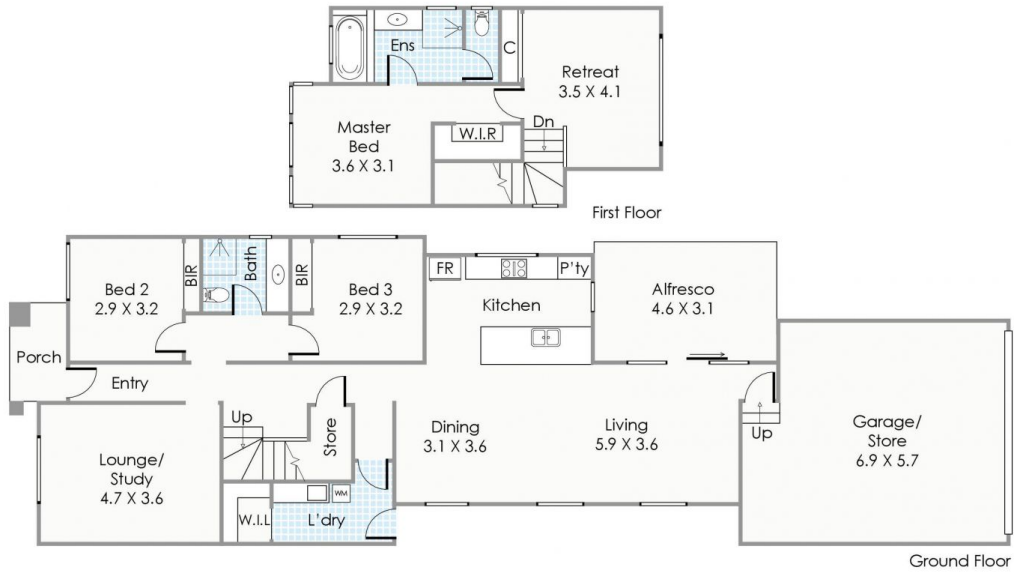

**Approximate Areas**

- Ground Floor: 137m<sup>2</sup>
- First Floor: 49m<sup>2</sup>
- Garage/Store: 41m<sup>2</sup>
- Alfresco: 14m<sup>2</sup>
- Porch: 5m<sup>2</sup>
- Total Area: 248m<sup>2</sup>

This floorplan is for illustration purposes only to show the layout of the property. Whilst every effort has been made to ensure the accuracy of this floor plan, all measurements, and any other information shown are an approximate interpretation only. Measurements and total areas do not include or account for wall thickness or roof area under eaves. Crib Creative will not be held liable or responsible for any error, omission, misrepresentation or use of any information shown on the final floor plan. Not to be used for any other purpose.  
www.cribcreative.com.au

**2 SLOMAN Lane, Clarkson**